

HARVARD ILLINOIS

HARVARD IS OPPORTUNITY

BUILD YOUR FUTURE HERE

www.harvardedc.com

Harvard offers a proactive business environment that provides expanding and relocating companies with the fast start that they need to succeed. The Harvard Economic Development Corporation (HEDC) acts as the gateway to the opportunities that exist throughout Harvard by providing access to the information, incentive programs and resources that your company needs.

If you're looking to grow your business, we can help you make good things happen in Harvard.

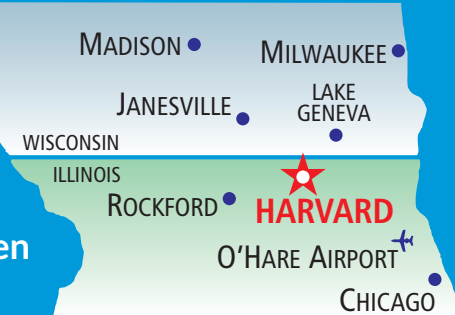

Opportunity Zone

Harvard is the only community in McHenry County to have a designated Opportunity Zone – a tax incentive which makes it possible to re-invest unrealized capital gains in commercial and residential development in Chemung Township, west of US 14. Investors receive a tax benefit in the form of deferred, reduced or eliminated capital gains by investing capital from Qualified Opportunity Funds in an eligible project in Harvard.

Enterprise Zone

The [Harvard-Woodstock Enterprise Zone](#) covers an area of approximately 7.75 square miles. The Enterprise Zone provides expanding companies with incentives that can include tax abatements, income tax credits, sales tax exemptions on the purchase of materials used in manufacturing and utility tax exemptions.

[Contact Enterprise Zone Administrator Charles Eldredge](#) for details.

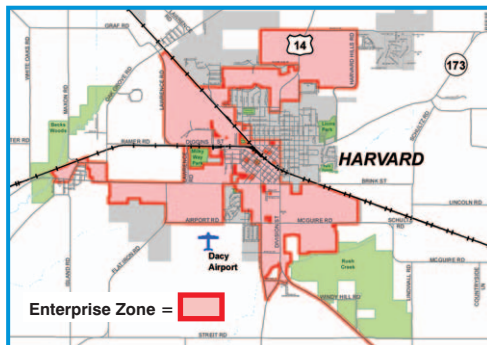

Foreign Trade Zone

Harvard is also part of [Foreign Trade Zone No. 176](#), which is administered through Chicago Rockford International Airport. FTZs are considered outside of U.S. Customs Territory for the purpose of customs duty payment. Goods entering FTZs are not subject to customs tariffs until the goods leave the zone.



Other Incentives

Harvard has three TIF Districts, including Downtown, Arrowhead Industrial Park and South Route 14. The City of Harvard also has a Downtown Façade Fund and Competitive Communities initiatives. Other loan and incentive programs may be available. [Contact the HEDC](#) for details.

HARVARD DELIVERS:

Harvard offers a compelling Bundle of Benefits to expanding and relocating companies which includes:

- Opportunity Zone
- Harvard-Woodstock Enterprise Zone
- Pro-Business City Government
- Arrowhead Industrial Park Phase III
- Affordable Shovel-Ready Sites
- Lower Operating Costs
- Well-Trained Workforce
- Lowest Residential Impact and Building Fees in McHenry County
- Fast-Track Permitting
- Abundant Water and Sewer Capacity
- Free Online Land and Sites Search



Contact Executive Director Charles Eldredge • (812) 390-3123
Visit www.harvardedc.com for Land and Site Opportunities

Success Comes Naturally Here

www.harvardedc.com





GROWTH IS HAPPENING HERE

Harvard's economic expansion is underway, with Arrowhead Industrial Park in Phase III and multiple retail districts taking root throughout the community. Major redevelopment projects are in the works. Our community is experiencing international investment and global attention.

YOU'LL FIND IT ALL IN HARVARD

General Information

Harvard has a growing population and a well-trained workforce with the ability to serve a wide range of industries. Nearly 130,000 people live within 15 miles of downtown Harvard, making the community an employment and retail center.

Primary County – McHenry County, Illinois

Greater Harvard Area – ESRI Data

HARVARD MARKET REACH SNAPSHOT:

DISTANCE – POPULATION*

15 miles – 127,343

10 miles – 30,303

5 miles – 12,804

* ESRI Data

	Population	Households	Labor Force	Businesses
5 Miles	12,804	4,351	6,336	383
10 Miles	30,303	10,928	15,277	687
15 Miles	127,343	47,085	66,248	3,176

Population

	2000	2010	2018	2023(Est.)
Harvard	7,996	9,447	9,130*	
Greater Harvard Area (5 mi)	12,218	12,846	12,804	13,729
McHenry County	260,077	308,760	308,570*	
County Labor Market	139,396	180,783	218,467**	

Sources: *ESRI Data **ACS Estimate

Community Facilities (Available within 10 miles)

Harvard is a short drive from the expansive resort, conference, dining and recreational opportunities offered in Lake Geneva, WI and Rockford, IL.

Local Harvard Facilities

Motels/Hotels	1	Public Golf Courses	2
Number of Rooms	60	Public Swimming Pools	1
Capacity of Largest Banquet Room	350	Public Library	1
Churches	17 Various Denominations		

Health Facilities

Mercyhealth Hospital and Medical Center - Harvard continues its long-standing commitment to the Harvard community with a hospital, two medical centers and a 45-bed long-term care facility. The Hospital, specialty medical center and a Care Center that provides short and long-term care are located in the center of town on their campus and their second medical center is located on Hwy 14. Mercyhealth Harvard provides a 24/7 emergency department, medical/telemetry, surgical, ICU and ancillary services (including Lab, Radiology, Nuclear Medicine, Respiratory Therapy, Cardiac Rehabilitation and more) and the medical center offers both primary and specialty care physicians.



Emergency Medical Treatment – Yes

Total Number of Beds: Inpatient – 15, ICU 3, Emergency – 5

Operating Room and Procedure Room Suites – 3

Clinic – Yes Doctors on Staff – 81 Employees – 280

Visit Mercyhealth Hospital Harvard Campus at:
www.mercyhealthsystem.org

Economic Development Amenities

Municipal Services

Local Government: City Council, Mayor, Aldermen

Subdivision Ordinance with Design Standards in place

Municipal Zoning, County Zoning

Emergency 911 System



Commercial Services

General Waste Disposal Yes

Financial Resources

Number of Banks in Community 4

Total Combined Local Assets (2018) \$948,789,000

Arrowhead Industrial Park Is A Great Place to Grow

Harvard's premier commercial and industrial park offers access, affordability and flexible expansion potential for commercial, industrial, distribution and office uses with shovel-ready, fully-improved sites ranging from 1.5 to 100 acres in size. Rail access (Union Pacific) available at some sites. Arrowhead is located in the Opportunity Zone, Enterprise Zone, Foreign Trade Zone #176 and has its own TIF District. Affordable construction and operating costs, flexible lot design and a ready workforce have helped Arrowhead grow beyond projections. Now in Phase III, the park is home to nearly 20 world-class companies.

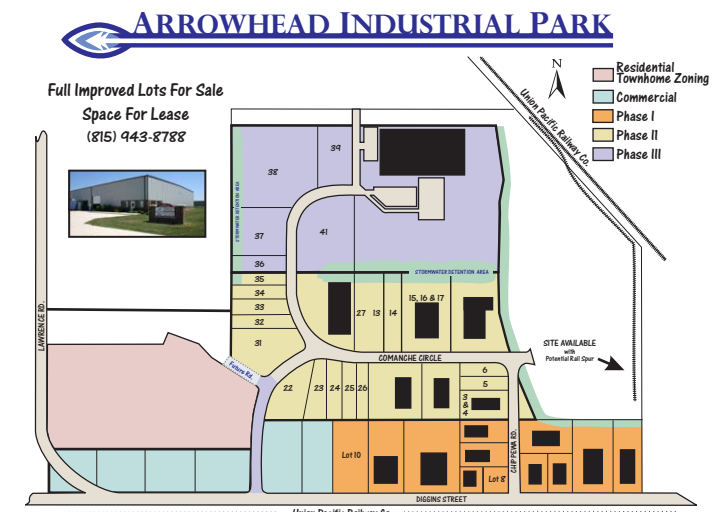



EMPLOYMENT

Nearly 500 companies call the Harvard area home. A sampling includes:

Employer	Product/Service
Ameriprint	Printing
Catty Corp.	Mfg.
Consolidated Container	Mfg.
CUSD50	School District
Dean Foods	Dairy Prods/Mfg.
Erect-a-Tube	Construction
Harvard State Bank	Bank
Mercyhealth Hospital Harvard	Healthcare
Pedigree Ovens	Pet Food Mfg.
True Value	Distribution Center
Walmart	Retail



Labor Force Composition, Harvard IL ESRI Data

Sector	Percentage
Agriculture	2.2%
Construction	5.4%
Education	14.6%
Finance/Insurance/Real Estate	2.9%
Government	6.4%
Healthcare	6.6%
Hospitality	1.1%
Manufacturing	14.5%
Retail Trade	20.9%
Transp./Utility/Comm.	4.2%
Other Services	13.4%
Wholesale Trade	7.8%

Labor Force Summary (McHenry County, 2018)

Total Labor Force
218,467*

Total Employment
154,675**

Harvard Employed
Population
6,338**

Source: * ACS est. ** Census.gov

UTILITIES

An existing High-Speed T1 Line connects Harvard to Chicago. A variety of communication resources make it easy to do business, including DSL, cable and wireless.

Municipal Water

High Quality, Capacity Available. Competitive water and sewer rates

	Gallons/Day	Liters/Day
Storage Capacity	1,550,000	5,890,000
Treatment Capacity	3,000,000	12,038,400
Average Daily Demand	900,000	3,420,000
Peak Daily Demand	1,100,000	4,180,000
Excess Capacity	2,068,000	7,858,400

Waste Water Treatment

Type of Sewage Treatment Plant	Secondary	
Treatment Capacity	1,800,000	6,840,000
Present Load	1,000,000	3,800,000
Excess Capacity	800,000	3,040,000

Natural Gas - Electricity - Telecommunications

Gas Supplier	Nicor
Electric Supplier	ComEd, Competitive
Local Telephone Supplier	AT&T
Digital Switching	Yes
Fiber Optics	Yes
High Speed Internet	DSL, Cable
T1 Line	Yes, Site Specific

TRANSPORTATION

Harvard offers fast and convenient access to major markets, with Union Pacific rail service and Metra commuter service to Chicago. The I-90/173 interchange provides fast access to Chicago, Rockford, Milwaukee and Madison.



Rail Service

Access to rail service is available at Arrowhead Industrial Park and other sites.

- Rail Service via Union Pacific - Piggyback Service Available

Harvard offers daily commuter rail service to and from Chicago and the northwest suburbs via Metra.

Motor Carrier

Highways Serving Community	1 - Federal	2 - State
Interstates Serving Community	I-90, I-43	
Nearest Interchange - 18 MI	Route 173/I-90	
Motor Freight Terminals	1	
Local Carriers	3	
Interstate Carriers	6	
Package Delivery Service - Yes		



Air

Harvard offers good access to Chicago's O'Hare Airport, Chicago-Rockford International Airport, Milwaukee's Mitchell Field and the Greater Madison Airport. Smaller public airports are nearby, including Dacy Airport in Harvard.

Harvard is also within one hour of the major FedEx hub in Madison, within a half hour of the UPS hub in Rockford and is located within Foreign Trade Zone #176 (Chicago-Rockford International Airport).

Nearest Commercial Airport:

Chicago O'Hare International Airport

Seven active runways; domestic/international cargo operations.

500+ commercial flights/day

83.2 million passengers/year

1.9 million tons of mail and freight/year



Nearest Public Airport:

Dacy Airport, Harvard

Grass surface; 3 lighted landing strips, 2,650 - 3,700 ft., lighted runway, with fuel, private storage and maintenance available.





EDUCATION AND RECREATION

The Harvard area offers a wealth of educational and training programs that are geared to creating good students, qualified workers and strong businesses. Workforce and small business development services are provided through nearby McHenry County College, its Shah Center for Corporate Training and the Illinois Small Business Development Center.

The college also offers two and four-year degrees through partnerships with Webster University and Columbia College. Northern Illinois University is only 40 minutes away, offering a full range of degree opportunities. Training incentives and subsidies exist for eligible companies.

Educational Facilities in Harvard

Harvard Community Unit School District 50 serves nearly 2,800 students from Pre-K-12 in five schools. Washington School serves the District's Pre-K student population. Crosby Elementary hosts Kindergarten through 3rd grade. Jefferson School houses 4th and 5th grade. Harvard Junior High consists of 6-8th grade and Harvard High School is home to 9-12th grade students. The District has 424 employees.

Harvard Community Unit School District 50 (2018)

Level	Number	Teachers	Enrollment
Pre-Kindergarten	1	10	217
Elementary	2	94	1,216
Jr. High	1	47	585
High School	1	69	709



Workforce Development Program

Harvard Community High School offers vocational training in areas including manufacturing technology, robotics and auto technician for students who are interested in pursuing careers in the industrial sector, nursing and emergency services for those who are interested in careers in healthcare, and entrepreneurship for future business owners.

Recreational Opportunities

The greater Harvard area is a four-season paradise for active individuals who enjoy the great outdoors.

Harvard residents and employees have access to a wide range of leisure activities, including golf, fishing, boating, hiking, biking, hunting and more.



The Harvard area has the largest number of dedicated conservation acres in the state of Illinois. The City of Harvard operates a network of City parks and resident recreation programs.

There are more than 40 golf courses within a 1/2 hour's drive of Harvard, including Oak Grove Golf Club, one of only a handful of Illinois courses to receive 4.5 stars from *Golf Digest*. The Lake Geneva resort area is a short drive away, offering world-class golfing, boating and other amenities.



Harvard is also the home of *Milk Days* (the longest-running festival in Illinois), *Harvard Balloon Fest* and the *4th Fridays* art festival held at the Starline Factory in downtown Harvard.

TAX STRUCTURE

Harvard tax rates are substantially lower than in Cook County and surrounding municipalities.

Note: property tax rates per \$100 assessed valuation. Valuation is 33.3% of real property, compared to Cook County where commercial property is assessed at 38% and industrial property is assessed at 36%.

Property Tax Rates — Year 2018

City	2.187869%
Others	9.019846%
Total	11.207715%

Property Tax Rates For Two Previous Years

2017	12.031339%
2016	12.343941%

Total Sales Tax Rate 7.00%



Harvard is home to a motivated, well-trained workforce with the ability to support a wide range of industries.

Site Selection, Development Programs and Other Information

Economic / Industrial Development Contact:
 Harvard Economic Development Corp.
 P. O. Box 623
 Harvard, IL 60033
 Phone: (812) 390-3123
 Email: info@harvardedc.com
 Website: www.harvardedc.com

Profile Information Provided By:
 City of Harvard
 201 W. Diggins Street
 Harvard, IL 60033
 Phone: (815) 943-6468
 Email: nelson@cityofharvard.org
 Website: www.cityofharvard.org

HARVARD sits on the Illinois-Wisconsin border in northern McHenry County, 60 miles northwest of Chicago and O'Hare International Airport, 35 miles east of Rockford Airport, and 60 miles southwest of General Mitchell International Airport in Milwaukee. The Lake Geneva recreational area is less than 20 miles north of Harvard. Many visitors pass through the Harvard on their way to or from Wisconsin, or to access Metra commuter train service to Chicago.

Contact the HEDC for information on economic development programs and incentives, and for a current listing of available sites and buildings. Visit our online Land and Sites Database at www.harvardedc.com